

VIEW B  
SHOWING CASE WITH LIDS REMOVED

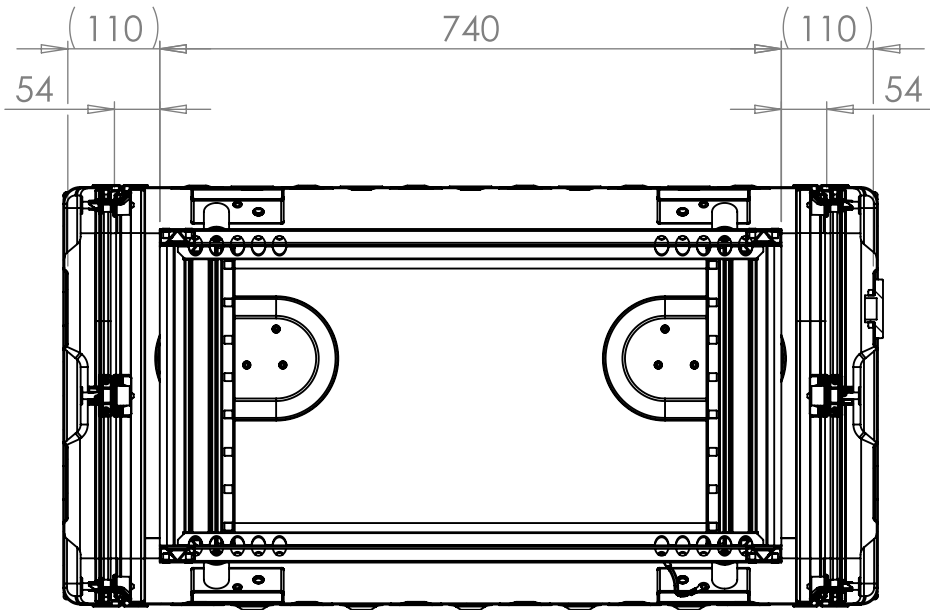
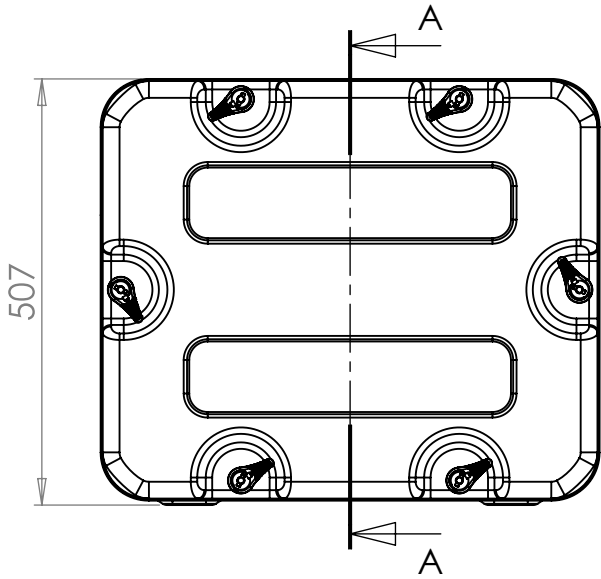
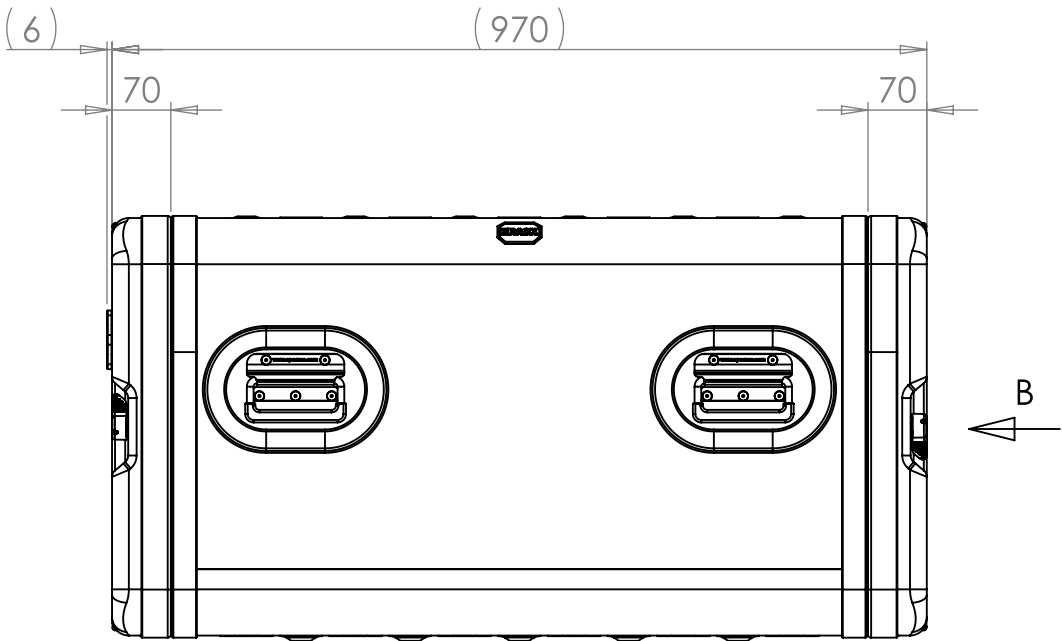
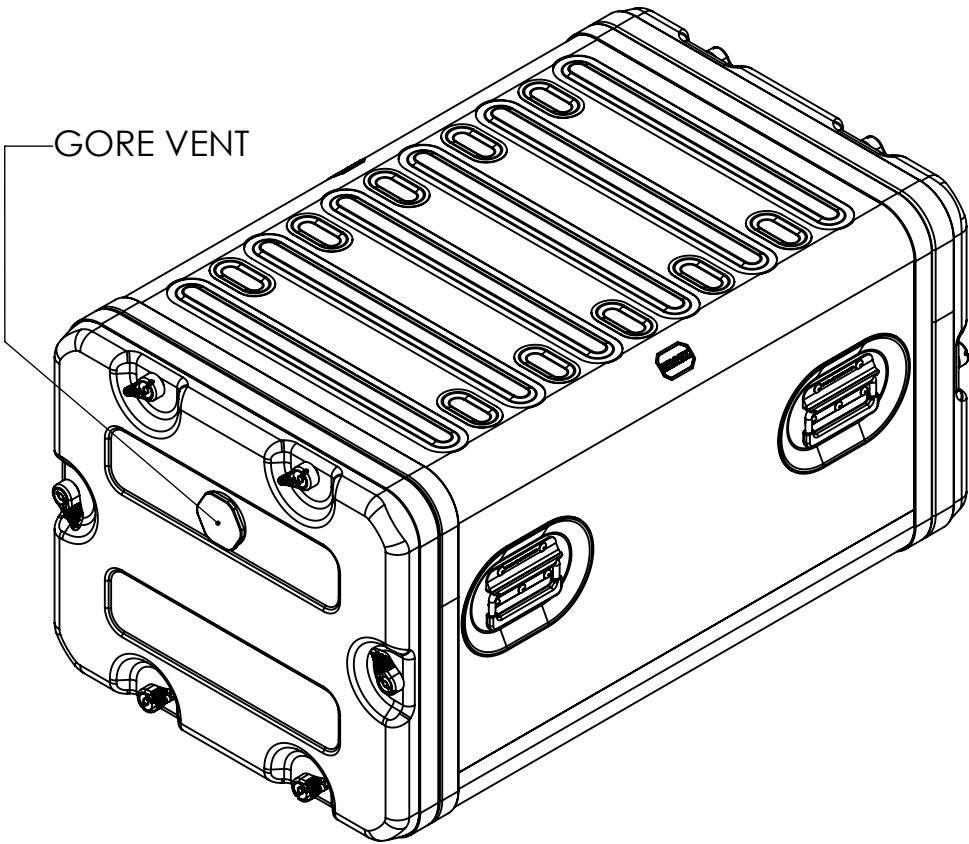

SECTION A-A  
SHOWING CHASSIS DETAIL

NOTES:  
1. APPROXIMATE WEIGHT: 20.1KG

Title ERV3 Case 8U 740mm Body/Lids	Material Aluminium	Finish Powdercoat Fine Texture (Other finishes available upon request)	Date	Drawn By JB	Revision /	Project ERV3	CP Cases Ltd.
			If in doubt ASK		Sheet No. 1 Of 1	Nato Stock No. -	
			Dimensions In Millimeters. Do Not Scale. Third Angle Projection.		Tolerance Unless Stated Otherwise. Moulding Tolerance +/- (1%+1mm). Sheet Metal Tolerance +/-0.5mm.		
Drg. No. RRV3-0874-0707	External Dimensions Height      Width      Length/ Depth	Internal Dimensions Height      Width      Length/ Depth					