

VIEW B  
SHOWING CASE WITH LIDS REMOVED

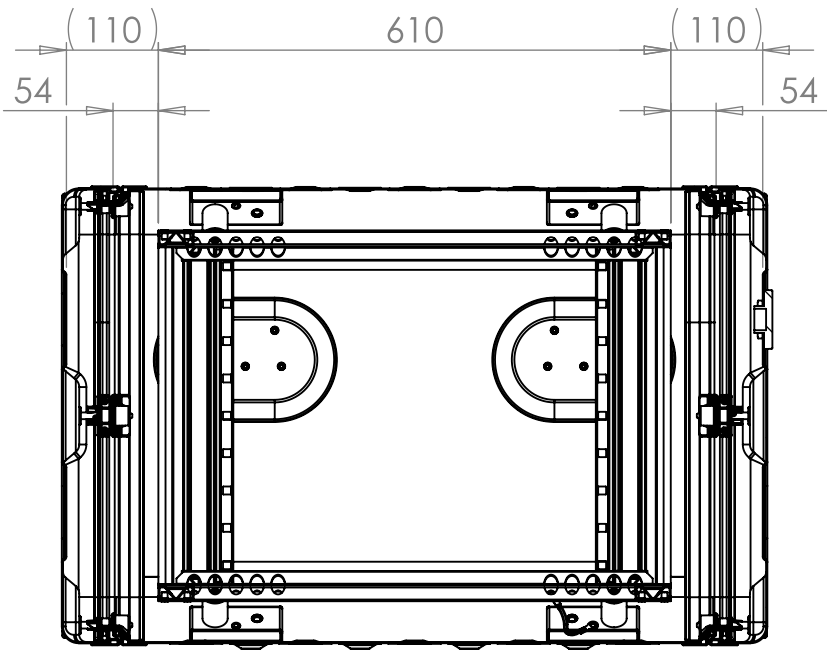
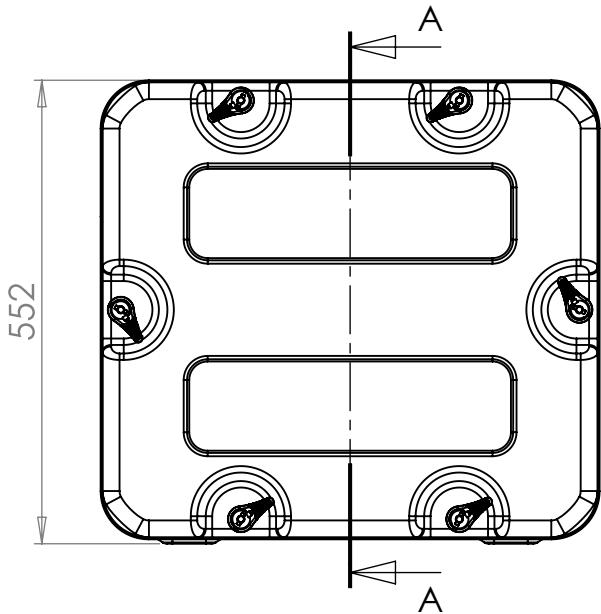
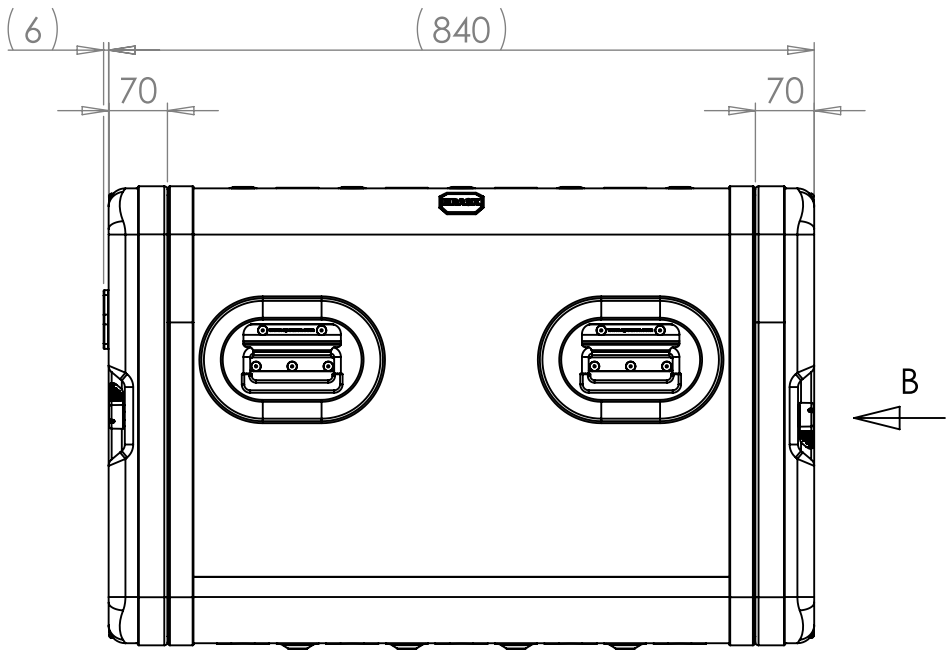
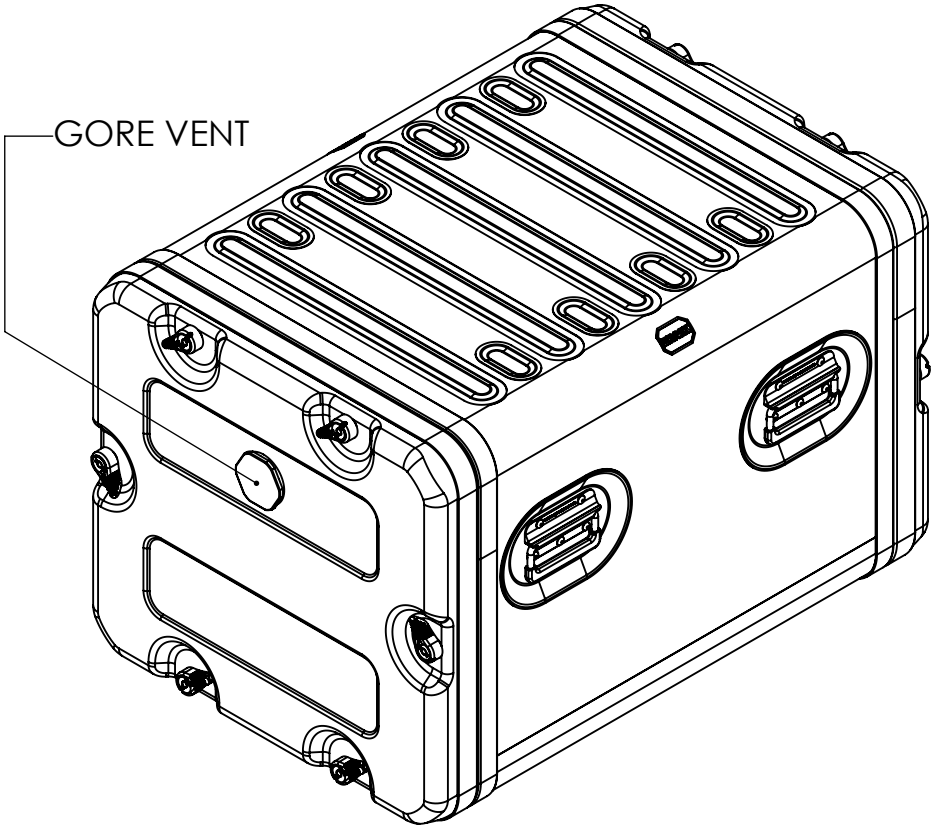

SECTION A-A  
SHOWING CHASSIS DETAIL

NOTES:  
1. APPROXIMATE WEIGHT: 19.5KG

Title ERV3 Case 9U 610mm Body/Lids	Material Aluminium	Finish Powdercoat Fine Texture (Other finishes available upon request)	Date	Drawn By JB	Revision /	Project ERV3	CP Cases Ltd.
			If in doubt ASK		Sheet No. 1 Of 1	Nato Stock No. -	
			Dimensions In Millimeters. Do Not Scale. Third Angle Projection.		Tolerance Unless Stated Otherwise. Moulding Tolerance +/- (1%+1mm). Sheet Metal Tolerance +/-0.5mm.		
Drg. No. RRV3-0961-0707	External Dimensions Height    Width    Length/ Depth	Internal Dimensions Height    Width    Length/ Depth					